

# LED Downlight

DLD4-008



## Features:

1. Professionally treated die-casting a-alloy housing.
2. Panel made of acrylic with super light transmission.
3. Exquisite appearance, visual appealing.
4. Easy heat dissipation secured long life of LED.
5. The separate design of power supply and the main body, further prolonged their lifespan.
6. High efficiency and energy saving LED driver.
7. An ideal replacement of the traditional canister light.

## Technical Parameter:

Voltage: 100-240V AC, 50/60Hz

Power: 8W

Led Q'ty: 18

PF: >0.9

Weight: 0.34kg

## Dimensions(unit:mm/inch):

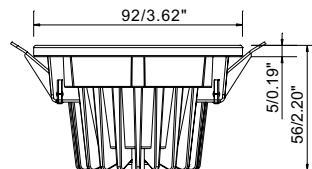
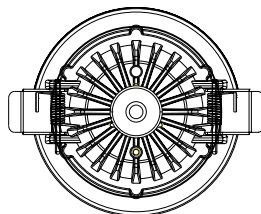

## Specification:

Model Number	Color	LED Type	Light Output (lm)	CCT	Beam angle	Power Consumption	Voltage	PF
DLD4-008-AW-W	White	5730 SMD	722	5000-7000K	68°	8W	100-240V AC 50/60Hz	>0.9
DLD4-008-AW-WW	Warm white	5730 SMD	654	2700-3500K	68°	8W	100-240V AC 50/60Hz	>0.9
DLD4-008-AW-NW	Natural White	5730 SMD	686	4000-5000K	68°	8W	100-240V AC 50/60Hz	>0.9

## Installation drawing

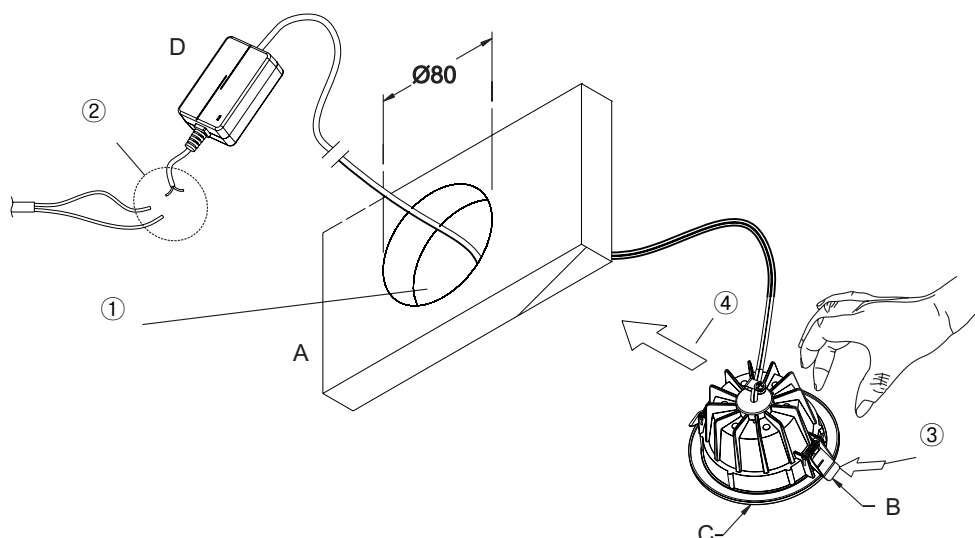

A	Wall
B	Spring
C	LEDlamp
D	Driver

①	make a hole
②	connect the powerwire
③	push spring
④	put the lamp into the hole

DLD4-008-AW-W

## Light Source Test Report

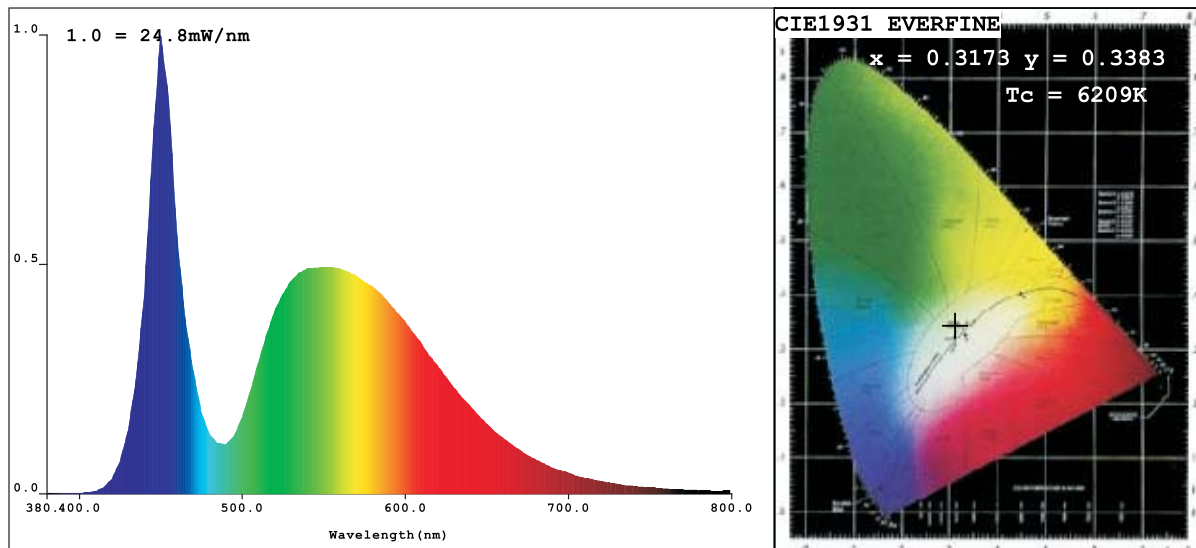

### CIE Color Parameters:

Chromaticity Coordinate:  $x=0.3173$   $y=0.3383$   $u'=0.1976$   $v'=0.4739$  ( $duv=5.61$ )

CCT:  $T_c = 6209K$  Prcp WaveL:  $\lambda_d = 495.7nm$  Purity=5.1%

Peak WaveL:  $\lambda_p = 450nm$  Half Width:  $\Delta\lambda_p = 20.7nm$  Ratio: R=12.2% G=83.9% B=3.9%

Average Wave: 545nm

Rendering Index:  $R_a = 72.1$

R1 =69 R2 =76 R3 =79 R4 =72 R5 =70 R6 =67 R7 =83 R8 =60

R9 =0 R10=42 R11=68 R12=36 R13=70 R14=88 R15=65

### Photo Parameters:

Flux:  $\Phi = 721.61(lm)$  Luminous Efficacy: 90.23(lm/W) Luminous Power:  $P = 2.206(W)$

### Electrical Parameters:

U=222.5V I=0.0377A P=7.997W PF=0.953

### Instrument Status:

Scan Range: 380.0nm-800.0nm  
REF = 14335

Interval: 5.0nm  
TMP(PMT) = 28.2(deg.celsius)

$I_p = 17772(G=3, D=48)$   
Test Mode: Fast Test

DLD4-008-AW-WW

## Light Source Test Report

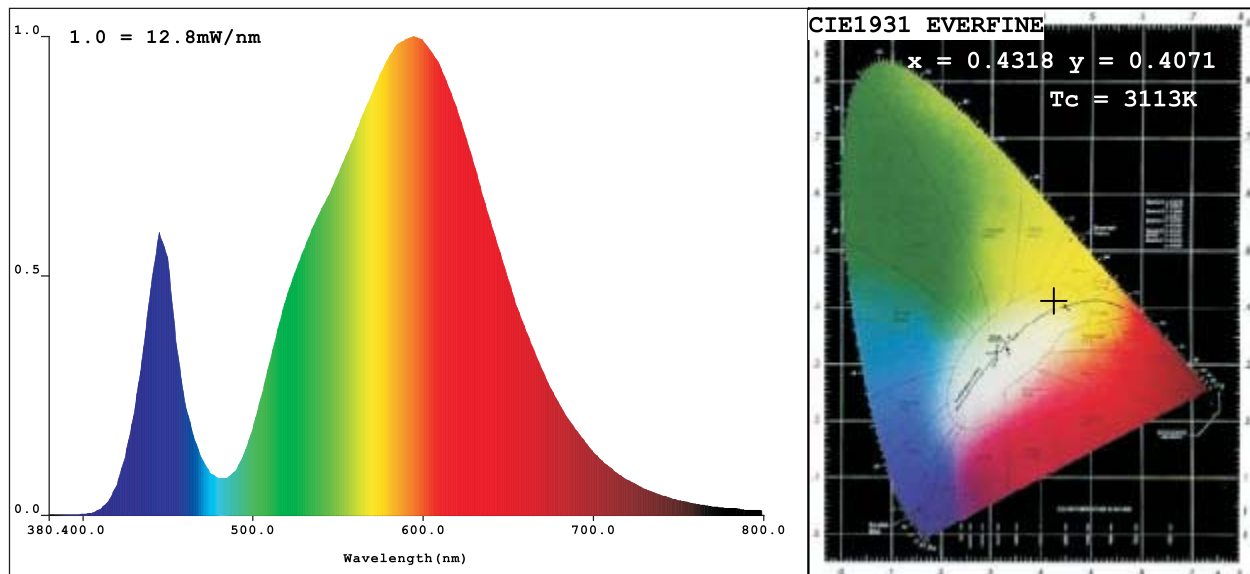

### CIE Color Parameters:

Chromaticity Coordinate:  $x=0.4318$   $y=0.4071$  /  $u'=0.2460$   $v'=0.5218$  ( $duv=1.94$ )

CCT:  $T_c = 3113K$  Prcp WaveL:  $\lambda_d = 581.7nm$  Purity = 51.8%

Peak WaveL:  $\lambda_p = 595nm$  Half Width:  $\Delta\lambda_p = 125.5nm$  Ratio: R=20.5% G=78.0% B=1.5%

Average Wave: 585nm

Rendering Index:  $R_a = 71.5$

R1 = 68 R2 = 79 R3 = 89 R4 = 70 R5 = 67 R6 = 70 R7 = 80 R8 = 49

R9 = 0 R10 = 51 R11 = 64 R12 = 43 R13 = 70 R14 = 93 R15 = 62

### Photo Parameters:

Flux:  $\Phi = 654.26(lm)$  Luminous Efficacy: 79.50 (lm/W) Luminous Power:  $P = 1.873(W)$

### Electrical Parameters:

U = 222.6V I = 0.0389A P = 8.229W PF = 0.951

### Instrument Status:

Scan Range: 380.0nm-800.0nm  
REF = 12974

Interval: 5.0nm

TMP (PMT) = 27.9 (deg.celsius)

$I_p = 21431 (G=4, D=49)$

Test Mode: Fast Test

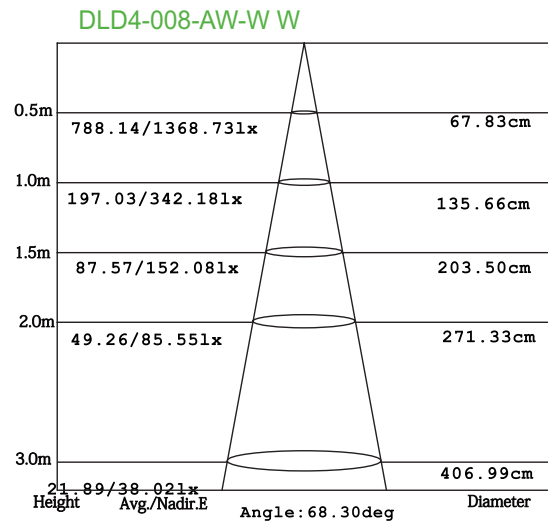
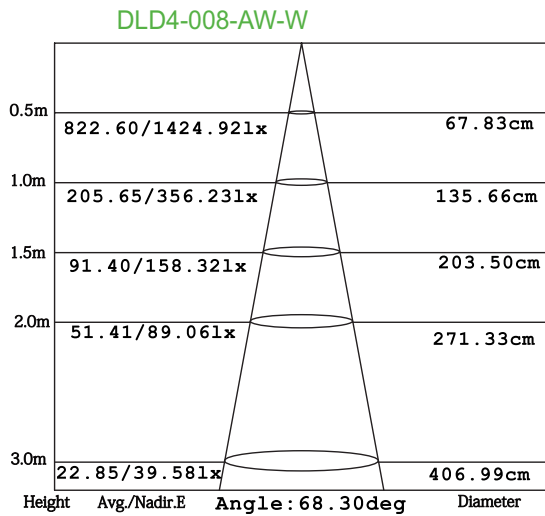

## Signcomplex Limited Warranty

Signcomplex warrants this product ("Product") against defects in material or workmanship for a period of three years from the date of purchase. If this Product is determined to be defective, Signcomplex will repair or replace the Product, at its option. This warranty does not cover cosmetic damage or damage due to acts of God, accident, misuse, abuse, negligence, commercial use, or modification of, or to any part of the Product. This warranty does not cover damage due to improper operation or maintenance, connection to improper voltage supply, or attempted repair by anyone than a facility authorized by Signcomplex to service the Product.

Repair or replacement as provided under this warranty is the exclusive remedy of the customer. Signcomplex shall not be liable for any incidental or consequential damages for breach of any express or implied warranty on this Product except to the extent prohibited by applicable law, any implied warranty of merchantability or fitness for a particular purpose on this Product is limited in duration to the duration of this limited warranty.

Some states do not allow the exclusion or limitation of incidental or consequential damages, or allow limitations on how long an implied warranty lasts, so the above limitations or exclusions may not apply to you. This warranty gives you specific legal rights, and you may have other rights which vary from state to state.

Only Signcomplex may change, amend or modify the terms of this Limited Warranty and any such change, amendment or modification shall be in writing and is sued by Signcomplex. To obtain warranty service and shipping information call +86 755 2760 8650 or e-mail [info@signcomplex.com](mailto:info@signcomplex.com). You must provide proof of purchase in the form of a bill of sale or receipted invoice which is evidence that the Product is within the warranty period to obtain warranty service. Consumers have legal rights under applicable national legislation governing the sale of consumer goods. Such rights are not affected by the warranties provision outlined in this document.

