

LED Panel Light

SC-PSC24WE3030-E



Features

- All sides are lined with LED's to grant optimal illumination.
- High light output at a reduced energy consumption of up to 50%.
- Over 30'000 hours life expectancy.
- Wide angle of deflection with even light distribution.
- No start-up time, no flickering, no humming.
- High efficiency (95%) constant current driver with built in overheat protection that remains stable at a wide range of input voltages.
- Independent LED circuit prevents complete blackout in case an LED fails.
- Environmentally friendly, mercury and lead free.
- Causes no electromagnetic interference.



Applications

- Hotels
- Conference / Meeting rooms
- Factories & Offices
- Commercial Purposes.
- Residential / Institution Buildings
- Schools, Colleges & Universities
- Hospitals
- Places where energy saving and high color rendering index lighting are needed.



Dimensions (Unit: mm/inch)

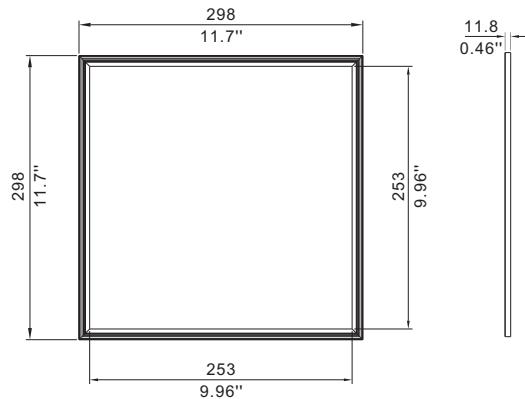

All dimension tolerance is $\pm 0.5\text{mm}$ unless otherwise noted.

Specifications

Model #	Color	LED Type	CCT	Rated Power Consumption	CRI	Luminous Flux	Working Voltage	Beam Angle	Weight
SC-PSC24WE3030-E	Warm White	SMD3020	2894K	13W	70.1	674lm	AC 100~240V	120°	1.1 kg

Average Illuminance Figure

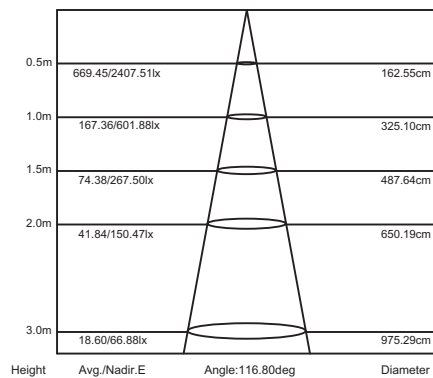

SC-PSC24WE3030-E

Absolute Maximum Rating

Parameter	Rating	Units
Aluminum Heat sink Temperature	70	° C
Operating Temperature	-20~+40	° C
Storage Temperature	-20~+80	° C
Equilibrium Temperature	58	° C

Electrical Connection

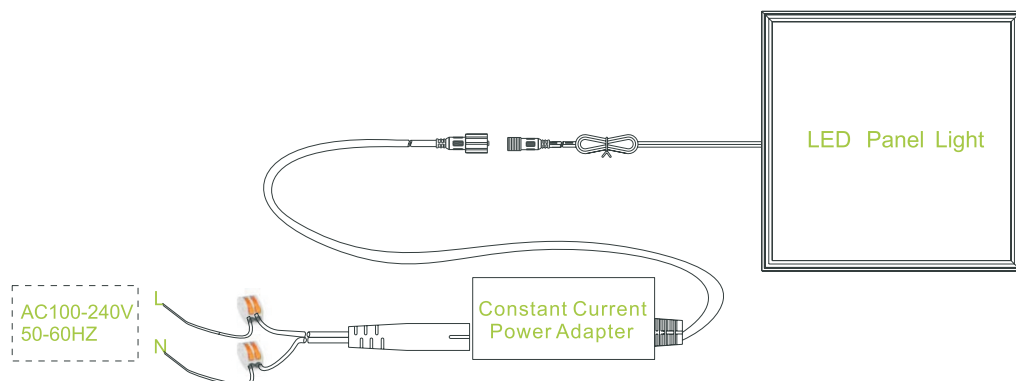

Installation instructions

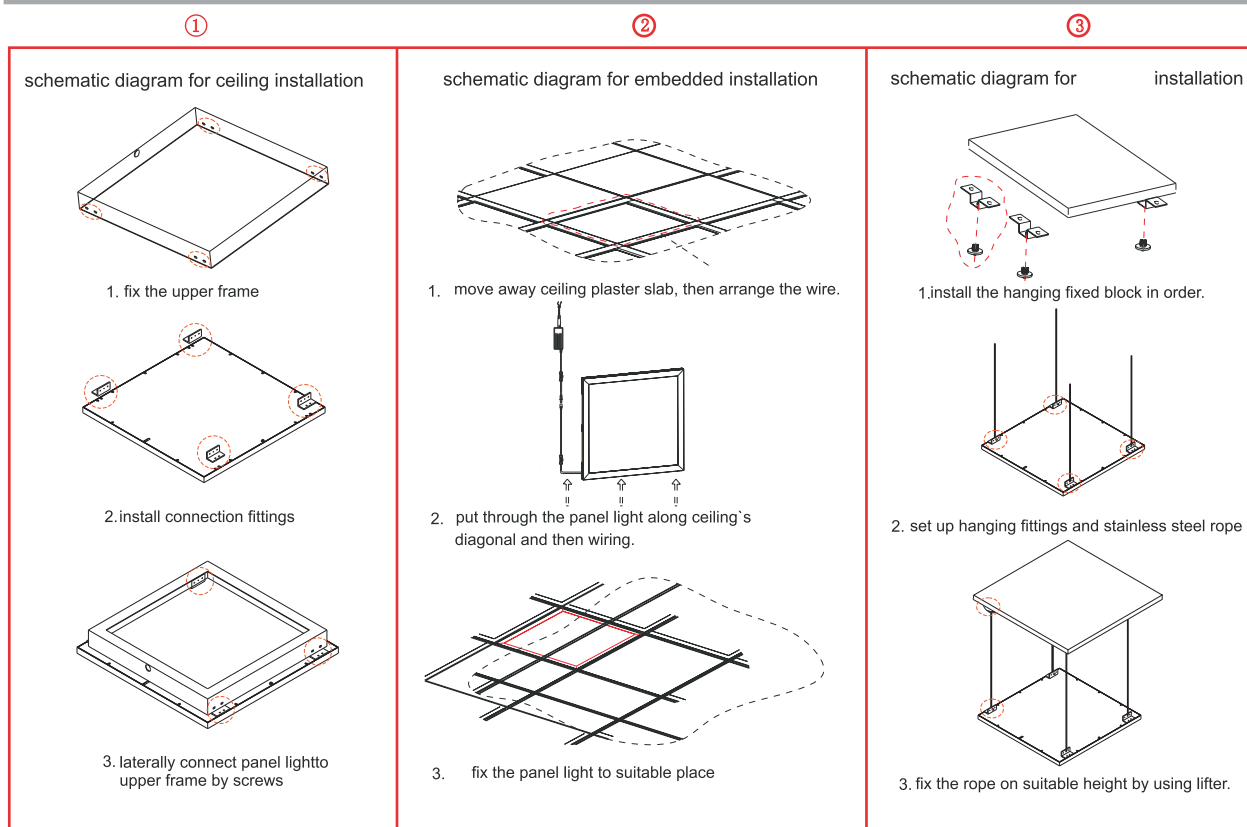

Install instruction:

1. turn off the power switch.
2. connect the input-terminal with utility power(AC 100-240V) by using wiring-unit, make certain that no copper wire is bared
3. connect the output-terminal DC plug of current driver with the lamp's DC plug ,insure this connection secure.
4. fix the lamp and current driver to the suitable place by convenient installation.
5. turn on the power switch.

SC-PSC24WE3030-E

Spectrophotometer Test Report

Light Source Test Report

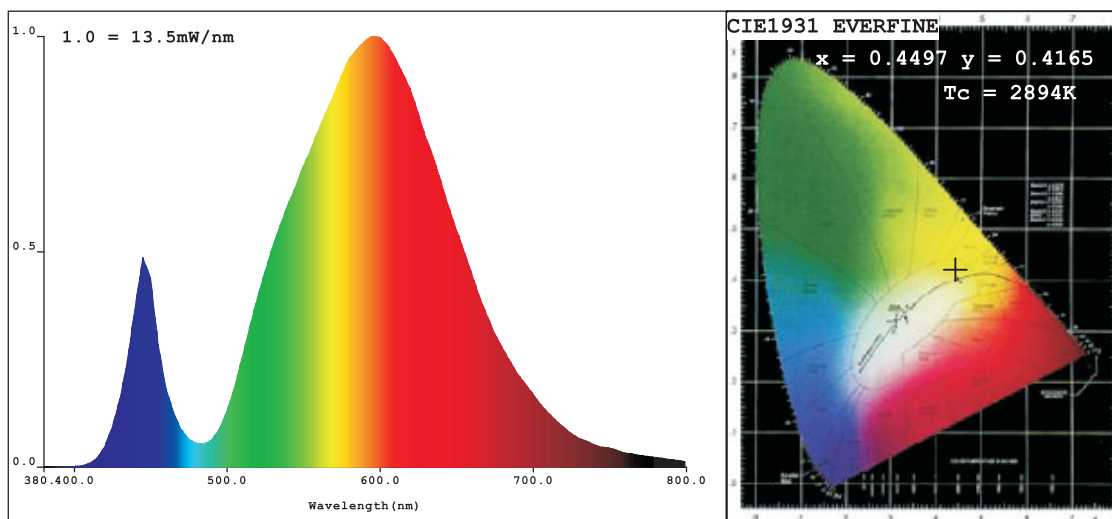

CIE Color Parameters:

Chromaticity Coordinate: $x=0.4497$ $y=0.4165$ / $u'=0.2534$ $v'=0.5281$ (duv=3.20)
 CCT:Tc= 2894K Prcp WaveL: d=582.3nm Purity=60.0%
 Peak WaveL: p=595nm Half Width: p=126.5nm Ratio:R=21.7% G=77.2% B=1.1%
 Average Wave: 591nm
 Rendering Index:Ra=70.1
 R1 =67 R2 =78 R3 =88 R4 =67 R5 =64 R6 =68 R7 =80 R8 =48
 R9 =0 R10=49 R11=60 R12=37 R13=68 R14=92 R15=61

Photo Parameters:

Flux: =673.96(lm) Luminous Efficacy: 54.21(lm/W) Luminous Power:P=1.953(W)

Electrical Parameters:

U=221.0V I=0.0583A P=12.43W PF=0.964

GONIOPHOTOMETER Test Report

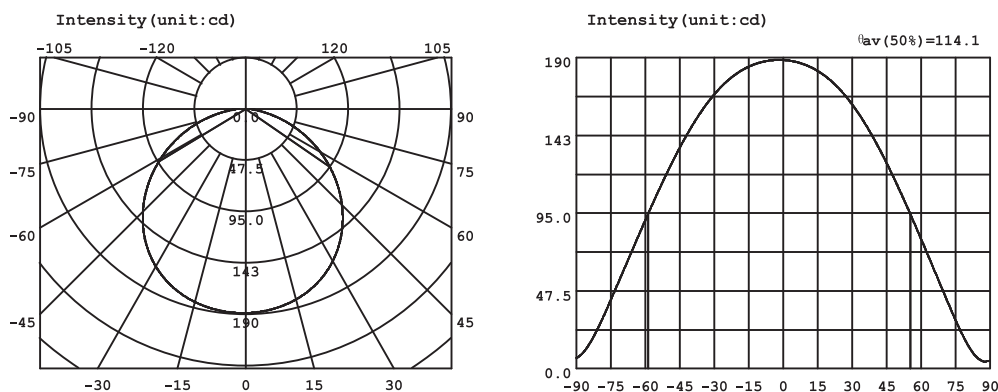

Packing Specification(mm)

1. All dimension units are millimeter.
2. 6 pcs inner box in one carton.

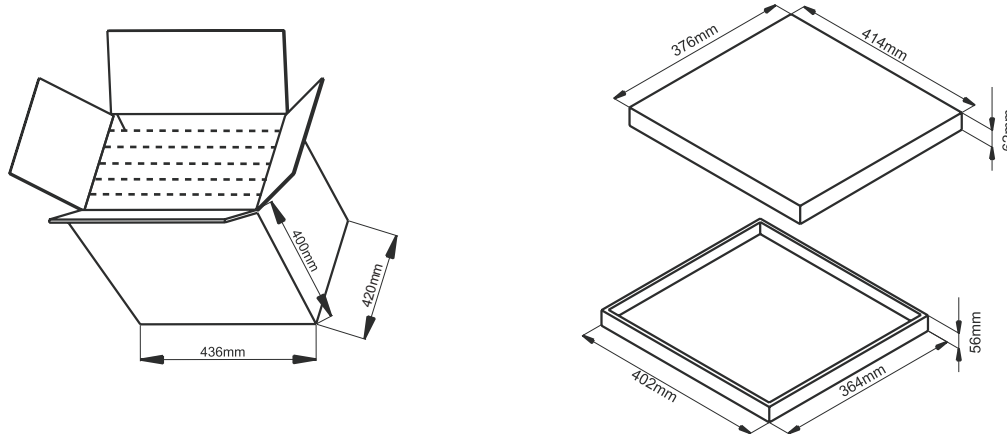

Signcomplex Limited Warranty

Signcomplex warrants this product ("Product") against defects in material or workmanship for a period of three years from the date of purchase. If this Product is determined to be defective, Signcomplex will repair or replace the Product, at its option. This warranty does not cover cosmetic damage or damage due to acts of God, accident, misuse, abuse, negligence, commercial use, or modification of, or to any part of the Product. This warranty does not cover damage due to improper operation or maintenance, connection to improper voltage supply, or attempted repair by anyone than a facility authorized by Signcomplex to service the Product.

Repair or replacement as provided under this warranty is the exclusive remedy of the customer. Signcomplex shall not be liable for any incidental or consequential damages for breach of any express or implied warranty on this Product except to the extent prohibited by applicable law, any implied warranty of merchantability or fitness for a particular purpose on this Product is limited in duration to the duration of this limited warranty.

Some states do not allow the exclusion or limitation of incidental or consequential damages, or allow limitations on how long an implied warranty lasts, so the above limitations or exclusions may not apply to you. This warranty gives you specific legal rights, and you may have other rights which vary from state to state.

Only Signcomplex may change, amend or modify the terms of this Limited Warranty and any such change, amendment or modification shall be in writing and is sued by Signcomplex. To obtain warranty service and shipping information call +86 755 2760 8650 or e-mail info@signcomplex.com. You must provide proof of purchase in the form of a bill of sale or receipted invoice which is evidence that the Product is within the warranty period to obtain warranty service. Consumers have legal rights under applicable national legislation governing the sale of consumer goods. Such rights are not affected by the warranties provision outlined in this document.